



JM VERY SEVERE HAIL PLATES

GET THE PROTECTION YOU NEED

INSTALL A VSH-RATED ROOF WITH JM

THE JM VSH PLATE

JM VSH Plates are 2.2" round heavy duty reinforced polymer plates with barbs utilized for in-seam single ply membrane securement, and cover board preliminary securement of Very Severe Hail rated single ply membrane systems.



MODERATE HAIL APPROVAL
UP TO 1" (QUARTER SIZE)

SEVERE HAIL APPROVAL
UP TO 1½" (GOLF BALL SIZE)

VERY SEVERE HAIL APPROVAL
GREATER THAN 2"
(EIGHT BALL SIZE)

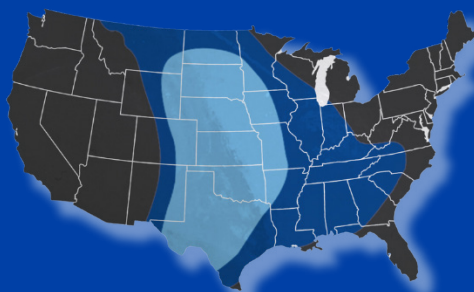

MECHANICALLY ATTACHED VSH ASSEMBLIES

557148-0-0	80 MIL TPO 6'	12" O.C.	1-90
557150-0-0	80 MIL TPO 8'	12" O.C.	1-75
557336-0-0	80 MIL TPO 6'	6" O.C.	1-135
557347-0-0	80 MIL TPO 8'	6" O.C.	1-105*
557320-0-0	80 MIL TPO 10'	6" O.C.	1-90*
557339-0-0	80 MIL TPO 12'	6" O.C.	1-75*

*22GA./80 KSI STEEL DECK

MECHANICALLY ATTACHED SYSTEM

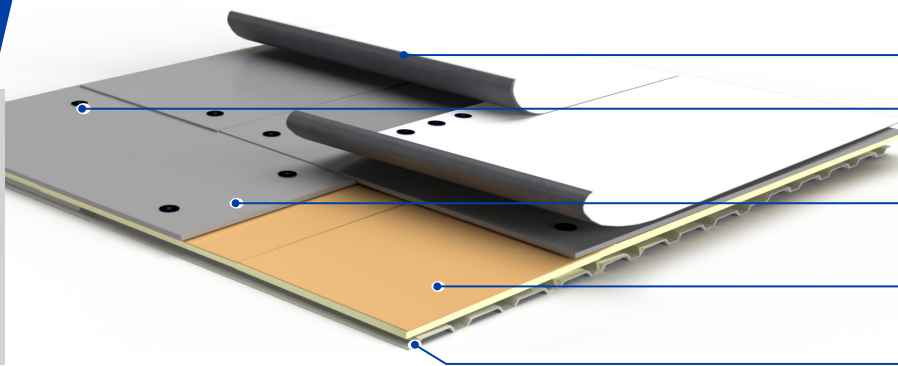

JM TPO 80 mil
(With High Load Fasteners and JM VSH Plates)

UltraFast® Fasteners and JM VSH Plates
(Min Four Plates Per Board for Preliminary Securement)

DensDeck® StormX™ Prime Roof Board

ENRGY 3® Insulation
(Loose Laid - Optional)

Steel Deck

DensDeck® StormX™ Prime VSH Plate Securement

The JM VSH Plate must be properly driven into the DensDeck StormX Prime Roof Board without over-driving or under-driving the fastener. Over-driving the fastener can cause "mushrooming" of the steel deck.

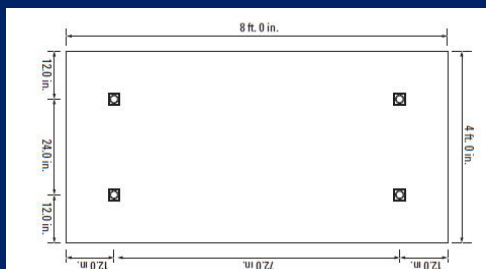

JM Coverboard Minimum Pre-securement Pattern when used with a Mechanically Fastened Membrane



Under-Driven Plate



Well-Driven Plate