

NOTES:

1. REFER TO JOHNS MANVILLE WEBSITE (www.jm.com) FOR MOST UP-TO-DATE INFORMATION.
2. PLEASE SEE SINGLE PLY FLASHING SPECIFICATIONS FOR A FULL DESCRIPTION OF INSTALLATION INSTRUCTIONS AND REQUIREMENTS WHICH ARE CONSIDERED A PART OF THIS DETAIL.
3. ANY CARPENTRY OR METAL WORK SHOULD BE DESIGNED AND CONSTRUCTED IN ACCORDANCE WITH LOCAL CODE REQUIREMENTS AND/OR PROJECT SPECIFICATIONS. THESE COMPONENTS SHOULD BE REVIEWED AND APPROVED BY A LICENSED DESIGN PROFESSIONAL. CONTACT JM TECHNICAL FOR METAL OPTIONS TO BE INCLUDED WITHIN THE JM NDL GUARANTEE.
4. BUTT JOINT AT ALL LOCATIONS A MAXIMUM 1" GAP BETWEEN EPDM SELF ADHERED MEMBRANES. EPDM SEALING STRIP IS USED TO SEAM EPDM SELF ADHERED MEMBRANE BUTT JOINTS. JM EPDM TAPE PRIMER OR JM SINGLE PLY MEMBRANE PRIMER (LOW VOC) MUST BE APPLIED ON ALL SURFACES COMING INTO CONTACT WITH JM EPDM PEEL & STICK PRODUCTS.
5. FOR JM APPROVED BASE FLASHING FASTENING METHODS SEE E-FW-B DETAILS.

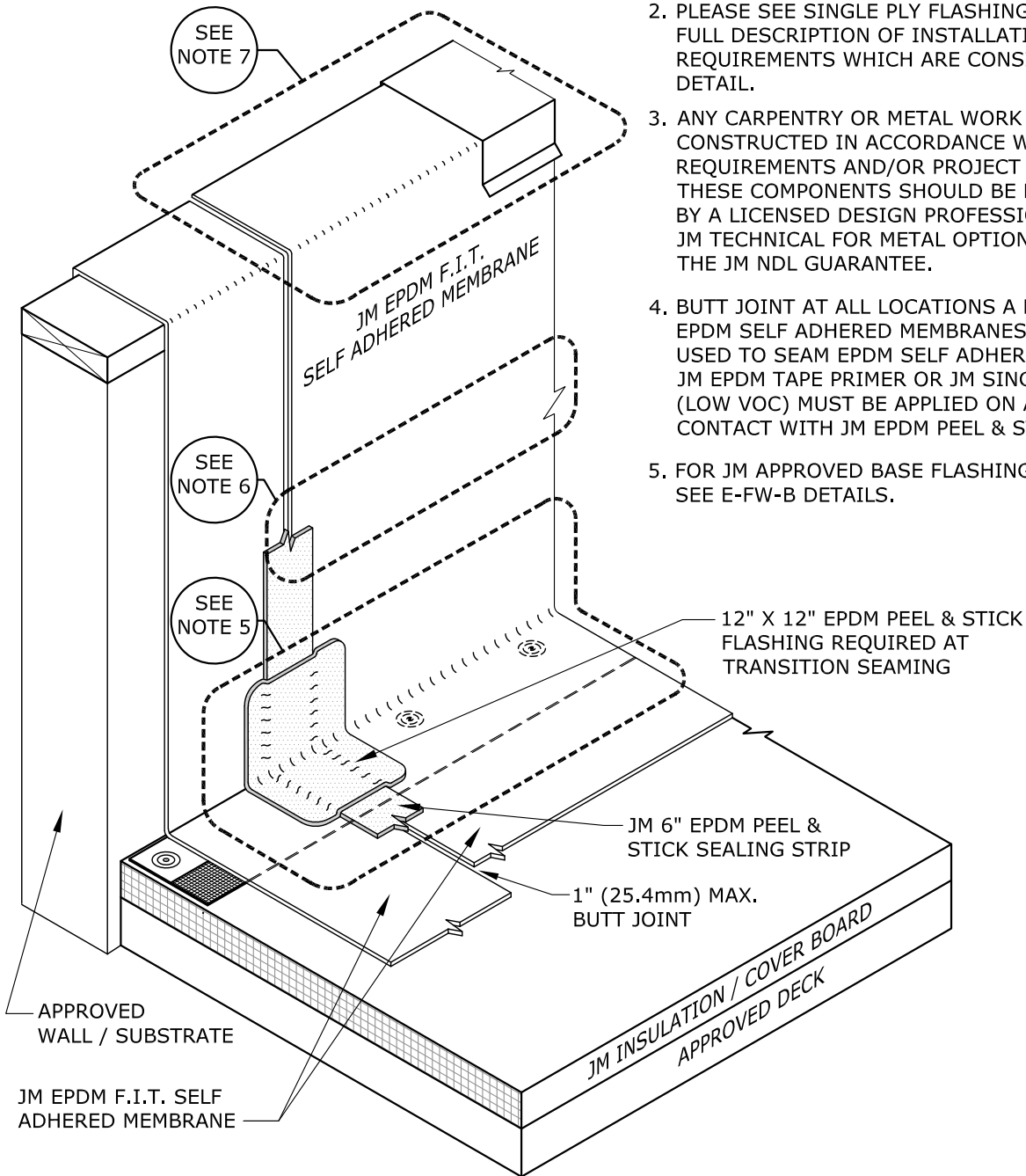

NOTES CONTINUED:

6. FOR JM APPROVED INTERMEDIATE FLASHING FASTENING METHODS SEE E-FW-I DETAILS. MINIMUM FLASHING TERMINATION HEIGHT IS 8" (203 mm) ABOVE ROOF SURFACE ON ANY JM APPROVED SUBSTRATE, IE. PLYWOOD, SECUROCK GYPSUM-FIBER, AND DENSDECK.
7. FOR JM APPROVED TOP OF WALL FLASHING METHODS SEE E-FW-T DETAILS.
8. ON RE-ROOFING PROJECTS, AN APPROVED ASPHALT BARRIER MUST BE INSTALLED OVER THE EXISTING SUBSTRATE TO FULLY SEPARATE THE JM EPDM FLASHING MEMBRANE FROM ANY INCOMPATIBLE MATERIALS.

DRAWING NO.

E-FW-M2I

JM EPDM SELF ADHERED BASE & WALL FLASHING WITH COPING

FLASHING WALL

MEMBRANE TYPE:
JM EPDM FIT SA

SCALE
N.T.S

ISSUE DATE
09-04-24

MAXIMUM GUARANTEE TERM:
N/A

Johns Manville is a manufacturer of commercial roofing products and offers this general conceptual information to you as a courtesy for general educational purposes only. This complimentary assistance is not to be either used or relied upon by anyone as a substitute for professional engineering design and documentation required by any building code, contract, or applicable law. By accepting the general conceptual information, you agree it does not constitute any representations, endorsements of, or an assumption by Johns Manville of any duty or liability for either the adequacy of the design of a building, any of its components or the sufficiency of any construction.

