

SCRIM VERTICAL VIEW  
STEP A

METAL OR CONCRETE SURFACE REQUIRES POWERED MECHANICAL ABRASION (SEE NOTE 5)

ENSURE FULL FINISH COAT SATURATION OF JM SP LIQUID FLASHING RESIN AFTER EMBEDDING SCRIM INTO BASE COAT (SEE NOTE 7)

TARGET AREA TAPE MASKING

APPROVED FIELD MEMBRANE FASTENERS  
TERMINATE JM SP LIQUID FLASHING RESIN 1/4"-1/2" BEYOND JM SP LIQUID SCRIM

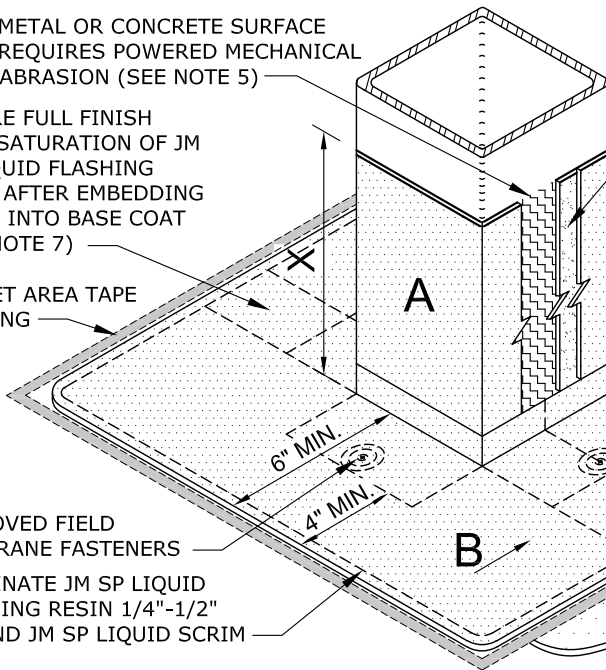

CUT JM SP LIQUID FLASHING SCRIM TO FIT SNUG AROUND PENETRATION AND PROVIDE A 1/4" MIN. UPTURN AROUND ENTIRE PENETRATION

APPROVED SUBSTRATE JM SP LIQUID FLASHING PRIMER (SEE NOTE 6)

JM SP LIQUID FLASHING SCRIM EMBEDDED INTO WET BASE COAT ONLY

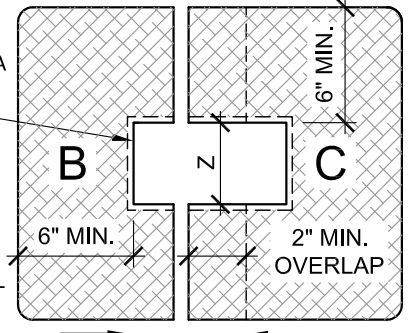

SCRIM HORIZONTAL VIEW  
STEPS B & C

JM SP FLASHING TPO & PVC PRIMER APPLIED TO JM SINGLE PLY SURFACE ROUGHED WITH 60 GRIT SAND PAPER REQUIRED

BASE COAT OF JM SP LIQUID FLASHING RESIN APPLIED WET WITHIN SUBSTRATE TARGET AREA

TPO OR PVC FIELD MEMBRANE ADHERED OR MECHANICALLY ATTACHED

**NOTES:**

- REFER TO JOHNS MANVILLE WEBSITE ([www.jm.com](http://www.jm.com)) FOR MOST UP-TO-DATE INFORMATION.
- PLEASE SEE JM SINGLE PLY LIQUID FLASHING SPECIFICATIONS FOR A FULL DESCRIPTION OF INSTALLATION INSTRUCTIONS AND REQUIREMENTS WHICH ARE CONSIDERED A PART OF THIS DETAIL.
- ANY CARPENTRY OR METAL WORK SHOULD BE DESIGNED AND CONSTRUCTED IN ACCORDANCE WITH LOCAL CODE REQUIREMENTS AND/OR PROJECT SPECIFICATIONS. THESE COMPONENTS SHOULD BE REVIEWED AND APPROVED BY A LICENSED DESIGN PROFESSIONAL.
- ALL SEALANTS / CAULKING SHALL BE PERIODICALLY INSPECTED AND MAINTAINED BY THE BUILDING OWNER THROUGHOUT THE LIFE OF THE ROOF.
- ALL METAL SURFACES REQUIRE POWERED MECHANICAL ABRASION TO BRING METAL DOWN TO A VIRGIN SURFACE. WIRE BRUSH IS NOT AN ACCEPTABLE ALTERNATIVE. CONCRETE AND MASONRY SURFACES REQUIRE POWERED GRINDER WITH ABRASIVE WHEEL FOLLOWED BY VACUUM AND/OR POWER WASH.
- METAL AND WOOD SUBSTRATE REQUIRES JM SP LIQUID FLASHING METAL & WOOD PRIMER. CONCRETE OR MASONRY SUBSTRATE REQUIRES JM SP LIQUID FLASHING CONCRETE PRIMER PRIOR TO JM SP LIQUID FLASHING RESIN APPLICATION.
- SECOND TOP COAT JM SP LIQUID RESIN ON VERTICAL SURFACES RECOMMENDED 24 HOURS AFTER INITIAL APPLICATION.
- JM SP LIQUID FLASHING RESIN CONSISTS OF A BASE COAT OF JM SP LIQUID FLASHING RESIN, A JM SP LIQUID SCRIM AND A FINAL COAT OF JM SP LIQUID FLASHING RESIN. USE THE APPROPRIATE JM SP FLASHING PRIMER DEPENDING ON TYPE OF SUBSTRATE.

DRAWING NO.

**SPL-FP-03**

PENETRATION

**TPO OR PVC SQUARE TUBE PENETRATION FLASHING**

MEMBRANE TYPE:

JM SP LIQUID TPO/PVC

SCALE

N.T.S

ISSUE DATE

04-17-20

MAXIMUM GUARANTEE TERM:

N/A

Johns Manville is a manufacturer of commercial roofing products and offers this general conceptual information to you as a courtesy. This complimentary assistance is not to be used or relied upon by anyone as a substitute for professional engineering design and documentation required by building code, contract, or applicable law. By accepting these comments you agree they do not constitute any representations, endorsements of, or an assumption by Johns Manville of any liability for either the adequacy of the design of this building or any other material not supplied by Johns Manville.

