

COMPLETE MEMBRANE COVER, INCLUDING 4" SHIP-LAPS, NOT SHOWN TO PROVIDE CLARITY OF OTHER COMPONENTS

EXPAND-O-FLASH (STYLE EJ/WC) ELASTOMERIC OR PVC BELLOWS AND FLASHING FLAP AND INTEGRAL NAILING FLANGES

FACTORY SEWN AND SEALED BELLOWS AT BELLOWS TRANSITION.

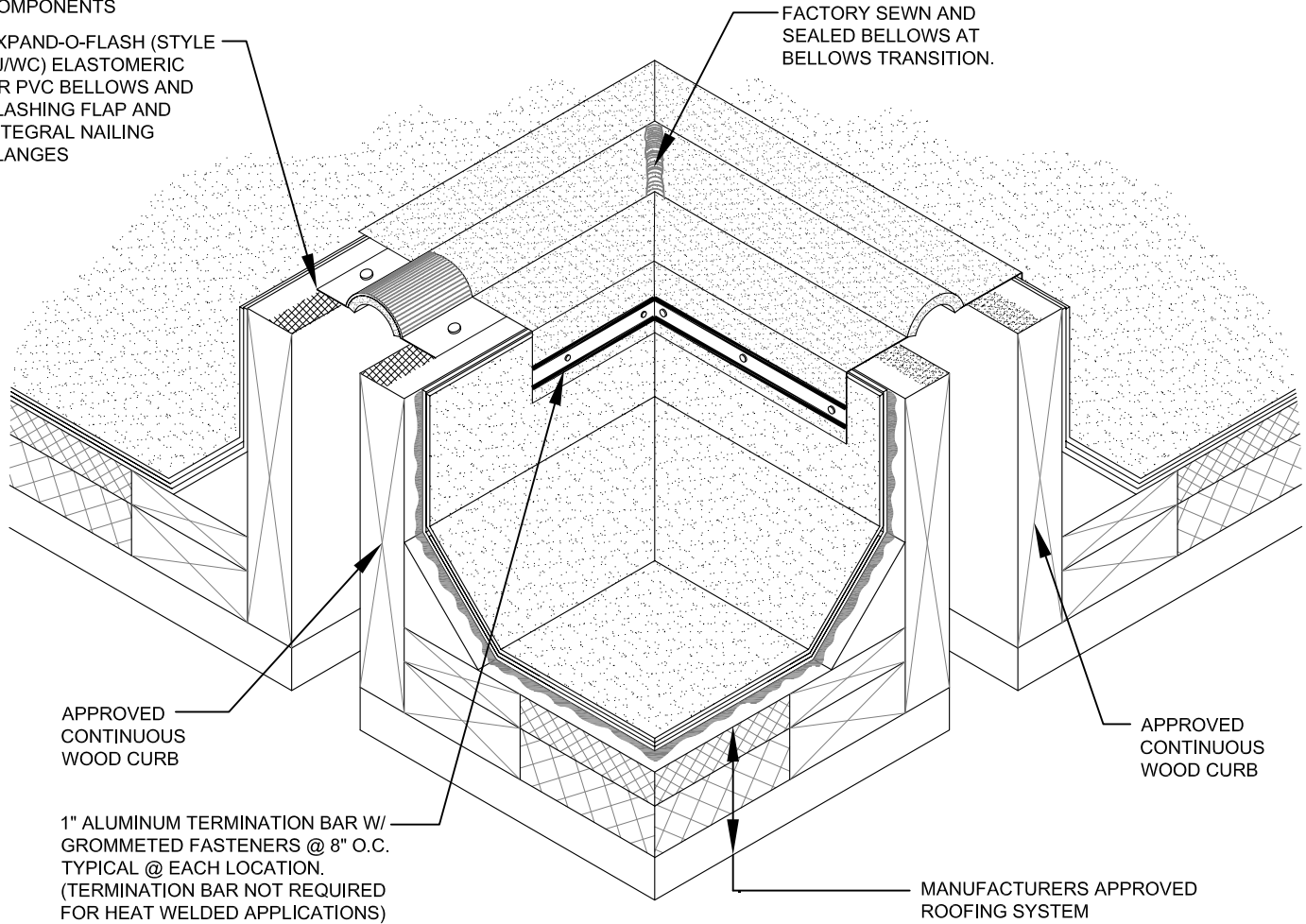

APPROVED CONTINUOUS WOOD CURB

APPROVED CONTINUOUS WOOD CURB

1" ALUMINUM TERMINATION BAR W/ GROMMETED FASTENERS @ 8" O.C. TYPICAL @ EACH LOCATION. (TERMINATION BAR NOT REQUIRED FOR HEAT WELDED APPLICATIONS)

MANUFACTURERS APPROVED ROOFING SYSTEM

NOTES:

- FOR ADDITIONAL APPLICATION INFORMATION OR TECHNICAL SERVICE PLEASE CONTACT OUR EXPAND-O-FLASH TECHNICAL SERVICE AT 800-445-1500
- THIS JOHNS MANVILLE PRODUCT CAN BE INCLUDED IN THE JM PEAK ADVANTAGE GUARANTEE. PLEASE CONTACT A JM TECHNICAL SERVICES SPECIALIST AT 800-922-5922 FOR SPECIFIC ROOFING AND FLASHING REQUIREMENTS.
- THIS DRAWING IS FOR REPRESENTATION PURPOSES ONLY. CONSULT EXPAND-O-FLASH TECHNICAL SERVICE FOR DEVIATIONS FROM THE ABOVE DETAIL
- SEE EXPAND-O-FLASH CUT SHEET FOR BELLOWS SIZING AND REQUIRED MOUNTING HEIGHT (IF APPLICABLE)
- CONTACT JM EXPAND-O-FLASH TECHNICAL SERVICE FOR INSTALLATION INSTRUCTIONS.

ROOF TO ROOF CORNER (STYLE EJ/WC)

DRAWING NO.

PF-21

SCALE

NTS

ISSUE DATE

5/9/12

REV. NO.

CAD FILE:

EOF TRANSITION DETAILS.DWG

Johns Manville is a Manufacturer of commercial roofing products and offers this general conceptual information to you as a courtesy. This complimentary assistance is not to be used or relied upon by anyone as a substitute for professional engineering design and documentation required by building code, contract, or applicable law. By accepting these comments you agree they do not constitute any representations, endorsements of, or an assumption by Johns Manville of any liability for either the adequacy of the design of this building or any other material not supplied by Johns Manville.

