

ROLL PATCHES INTO SEAMS WITH HAND ROLLER UNDER PRESSURE AND CREASE INTO SEAMS ACCORDING TO THE JM PVC APPLICATION GUIDE

JM SINGLE PLY LVOC CAULK UNDER THE PATCH AT T-JOINT INTERSECTION RECOMMENDED

JM PVC T-JOINT PATCH (NOTE 5)

1 1/2" (38mm) MIN. WELD CONTINUOUS

JM SINGLE PLY LVOC CAULK ALL AROUND T-JOINT PATCH

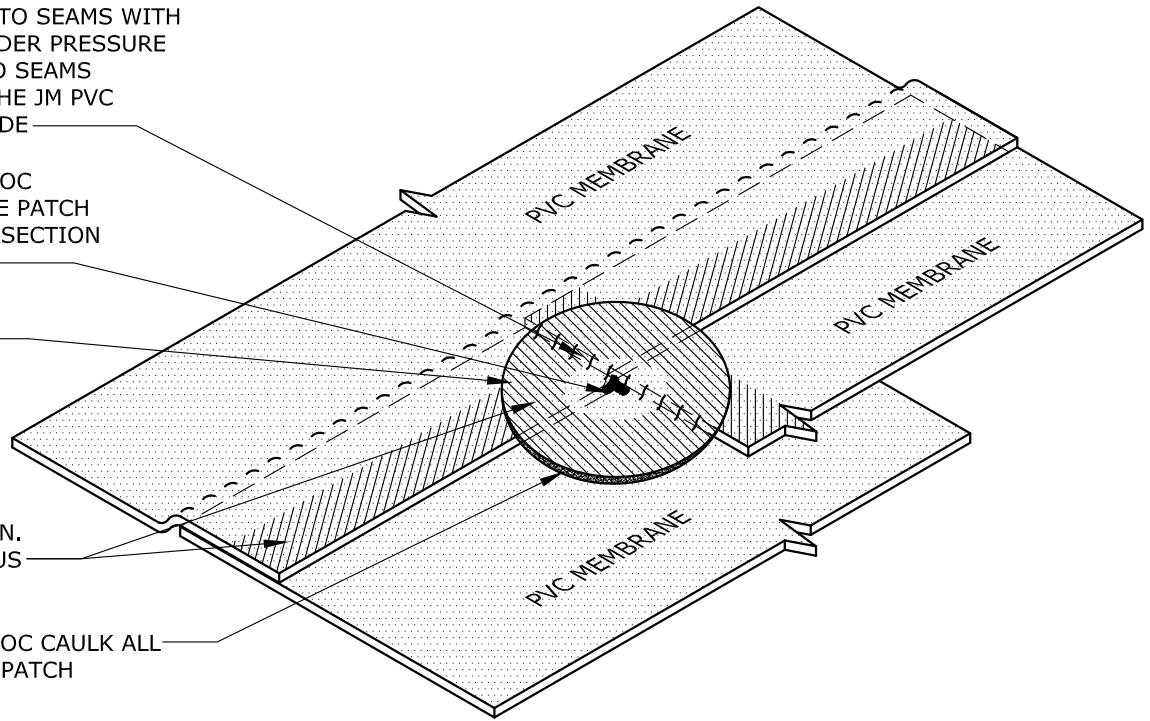

ISOMETRIC VIEW T-JOINT

JM PVC MEMBRANE ADHERED OR MECHANICALLY FASTENED

JM PVC MEMBRANE ADHESIVE (FOR ADHERED SPECIFICATIONS ONLY)

JM SINGLE PLY LVOC CAULK
JM PVC T-JOINT PATCH (NOTE 5)

1 1/2" (38 mm) MIN. WELD (CONTINUOUS)

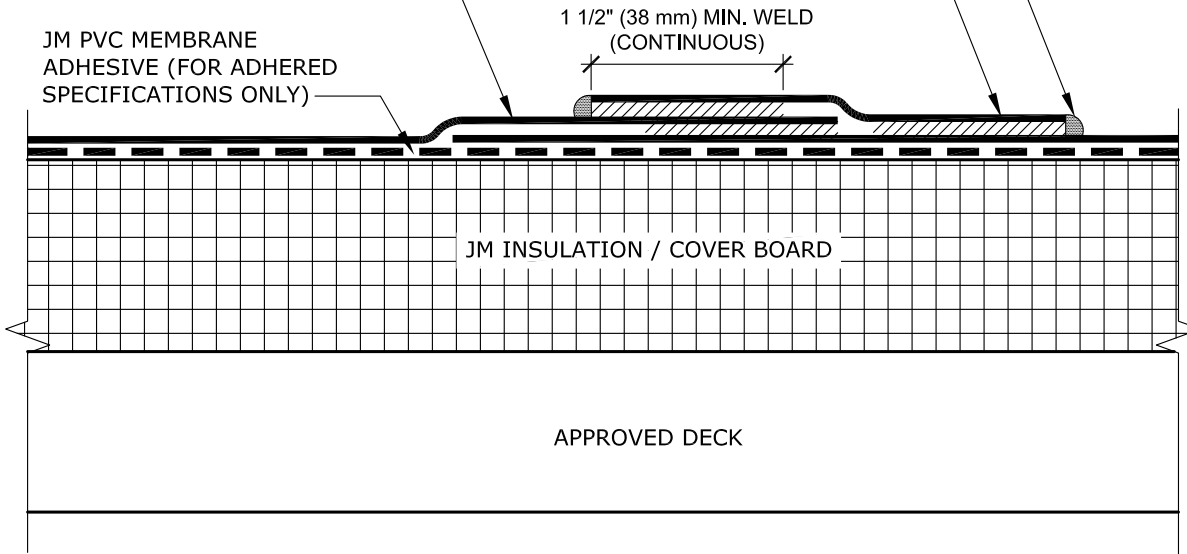

JM INSULATION / COVER BOARD

APPROVED DECK

NOTES:

1. REFER TO JOHNS MANVILLE WEBSITE (www.jm.com) FOR MOST UP-TO-DATE INFORMATION.
2. PLEASE SEE SINGLE PLY FLASHING SPECIFICATIONS FOR A FULL DESCRIPTION OF INSTALLATION INSTRUCTIONS AND REQUIREMENTS WHICH ARE CONSIDERED A PART OF THIS DETAIL.
3. ANY CARPENTRY OR METAL WORK SHOULD BE DESIGNED AND CONSTRUCTED IN ACCORDANCE WITH LOCAL CODE REQUIREMENTS AND/OR PROJECT SPECIFICATIONS. THESE COMPONENTS SHOULD BE REVIEWED AND APPROVED BY A LICENSED DESIGN PROFESSIONAL.
4. JM PVC EDGE SEALANT IS OPTIONAL ON ALL CUT OR NON-ENCAPSULATED EDGES OF REINFORCED MEMBRANE. THIS INCLUDES FACTORY CUT MEMBRANE (SEE DETAIL P-MS-01).
5. JM PVC T-JOINT PATCH IS REQUIRED FOR ALL PVC 72-MIL MIN, PVC 80-MIL, AND PVC SD PLUS 80-MIL MEMBRANE SYSTEMS.

DRAWING NO.

P-MS-17

MBR SEAMING

PVC T-JOINT PATCH

MEMBRANE TYPE:
JM PVC

MAXIMUM GUARANTEE TERM:
30 YEAR

SCALE
N.T.S

ISSUE DATE
07-28-22

Johns Manville is a manufacturer of commercial roofing products and offers this general conceptual information to you as a courtesy for general educational purposes only. This complimentary assistance is not to be either used or relied upon by anyone as a substitute for professional engineering design and documentation required by any building code, contract, or applicable law. By accepting the general conceptual information, you agree it does not constitute any representations, endorsements of, or an assumption by Johns Manville of any duty or liability for either the adequacy of the design of a building, any of its components or the sufficiency of any construction.

