

PEAK ADVANTAGE Johns Manville

Johns Manville offers one of the most comprehensive guarantees in the roofing industry. That's the advantage you can expect from a longtime, dependable leader with the financial backing of Berkshire Hathaway.

 **Johns Manville**
A Berkshire Hathaway Company

717 17th St.
Denver, CO 80202
(800) 922-5922
www.jm.com/roofing

 facebook.com/JohnsManville

 JohnsManvillevideos

 @JMRoofingSystem

 www.jmroofing.news

RS-6126 12-17 (NEW)

Johns Manville

JM EPDM R FIT (MF) APPLICATION STEPS

SINGLE PLY ROOFING

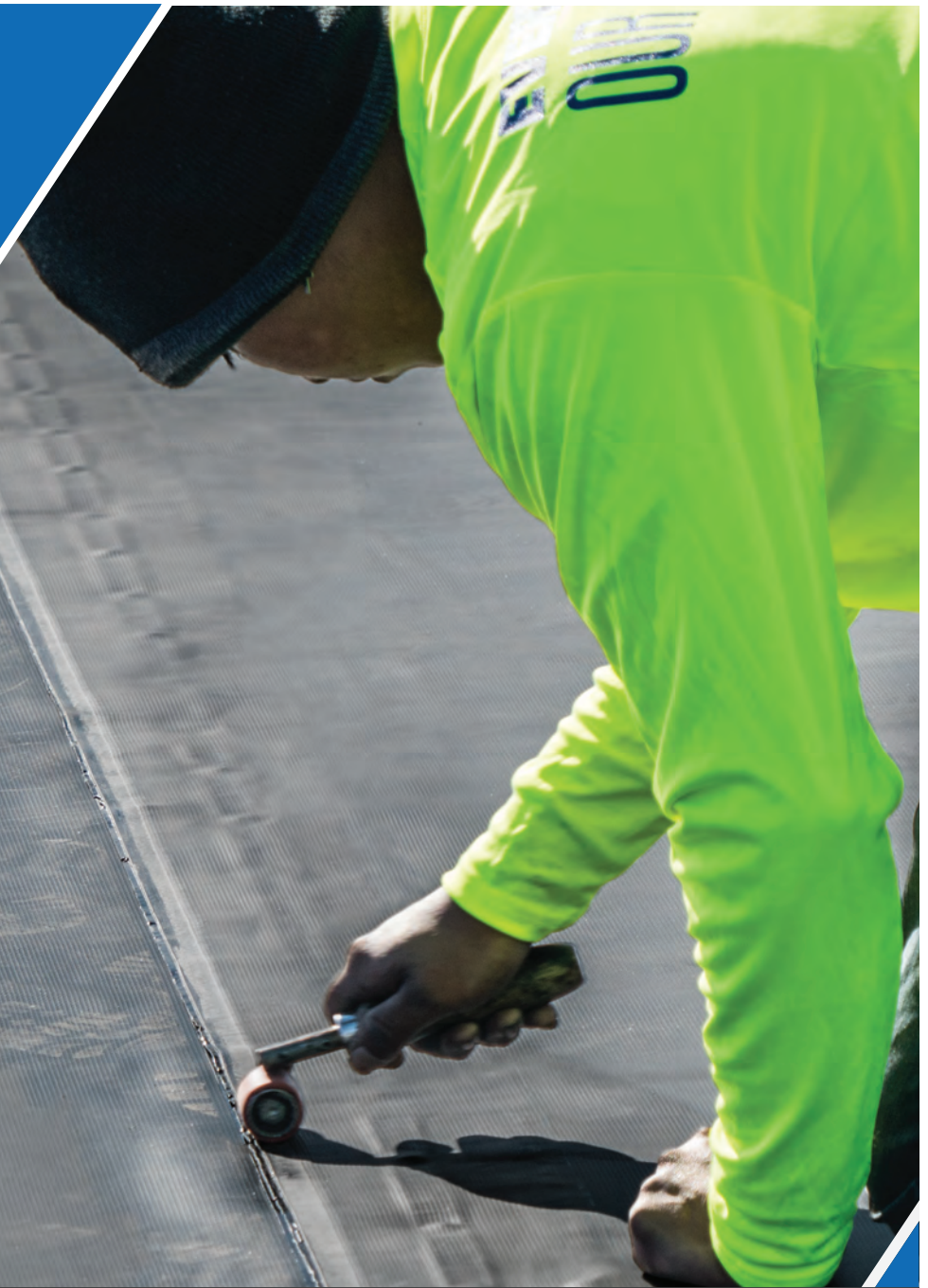

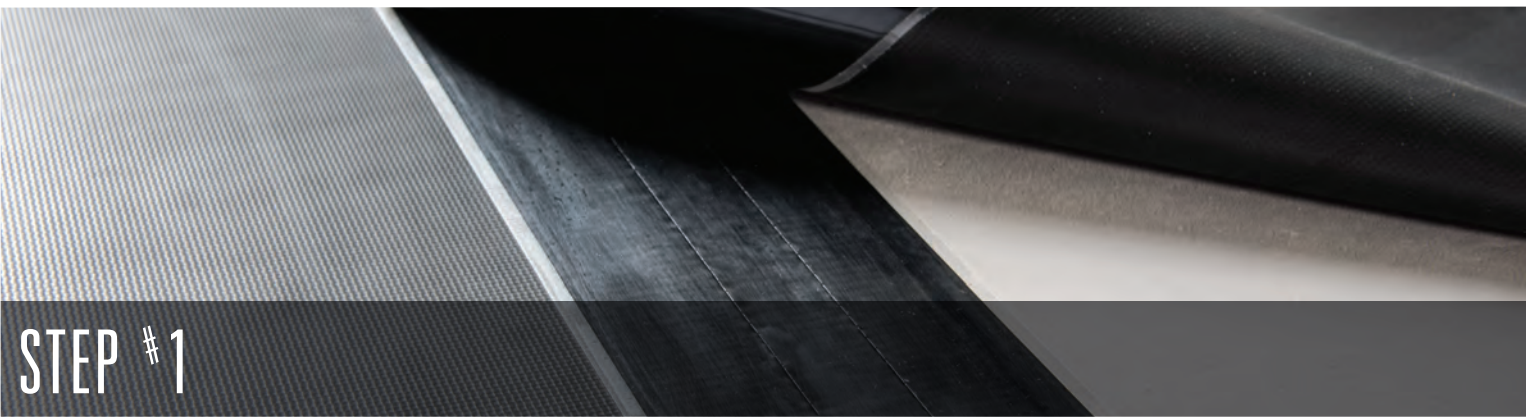

STEP #1

RELAX AND ALIGN

Roll out the first membrane sheet and allow it to relax. The sheets should be oriented so that the side with the perforated release liner is on the bottom facing up.



STEP #2

REMOVE CENTER SECTION

Remove the center section of the release liner to expose the tape.



STEP #3

POSITION BATTEN STRIP

Set the batten strip on top of the exposed tape along the length of the seam.

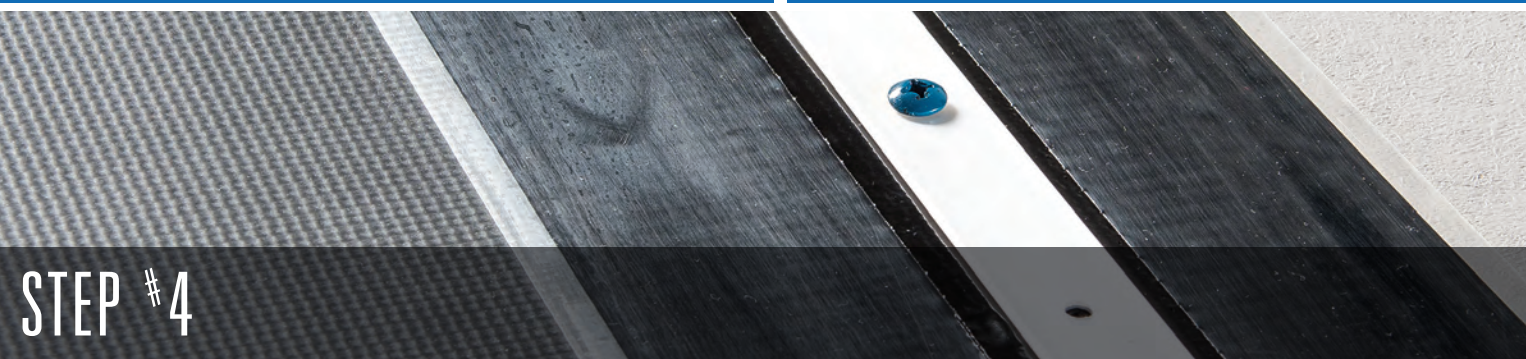

STEP #4

INSTALL FASTENERS

Tightly screw down the polymer batten strip. Be sure to drive the fastener perpendicular to the surface of the substrate. This will also ensure proper penetration of the deck surface.

ROLL OUT THE NEXT ADJACENT ROLL OF MEMBRANE AND POSITION IT SO ITS COMMON EDGE FULLY OVERLAPS THE POLYMER BATTEN STRIP.

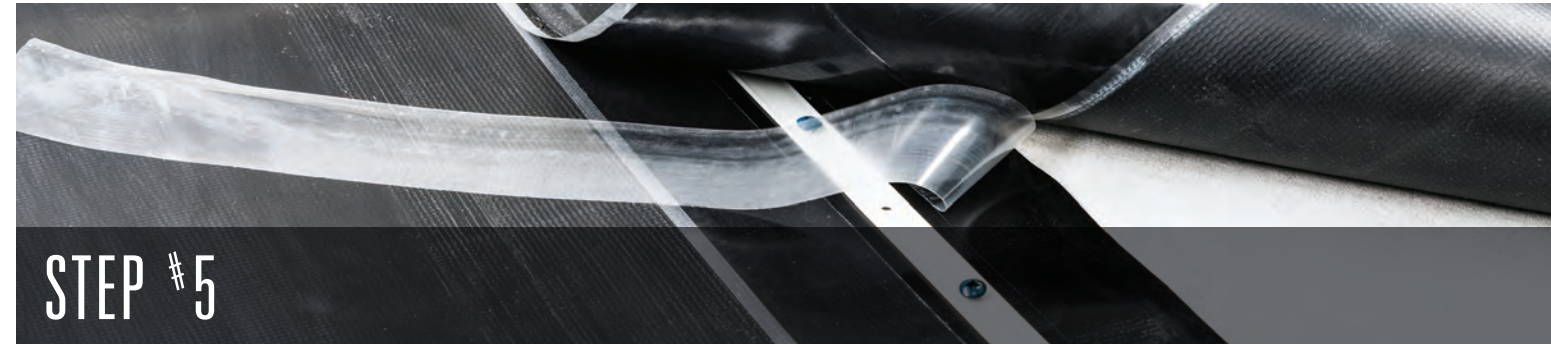

STEP #5

REMOVE INNER LINER

Fold the top sheet back to expose the secured seam and remove the inner lower release liner. Then fold the sheet back over the secured seam.



STEP #6

REMOVE REMAINING LINERS

Simultaneously remove the last two release liners by peeling them back parallel to the roof surface and away from the splice at a 45° angle.

IF PREFERRED, REMOVE THE LOWER OUTER RELEASE LINER FIRST, FOLLOWED BY THE TOP RELEASE LINER, BEING CAREFUL NOT TO EXCEED 18" OF DISTANCE BETWEEN THE TWO.

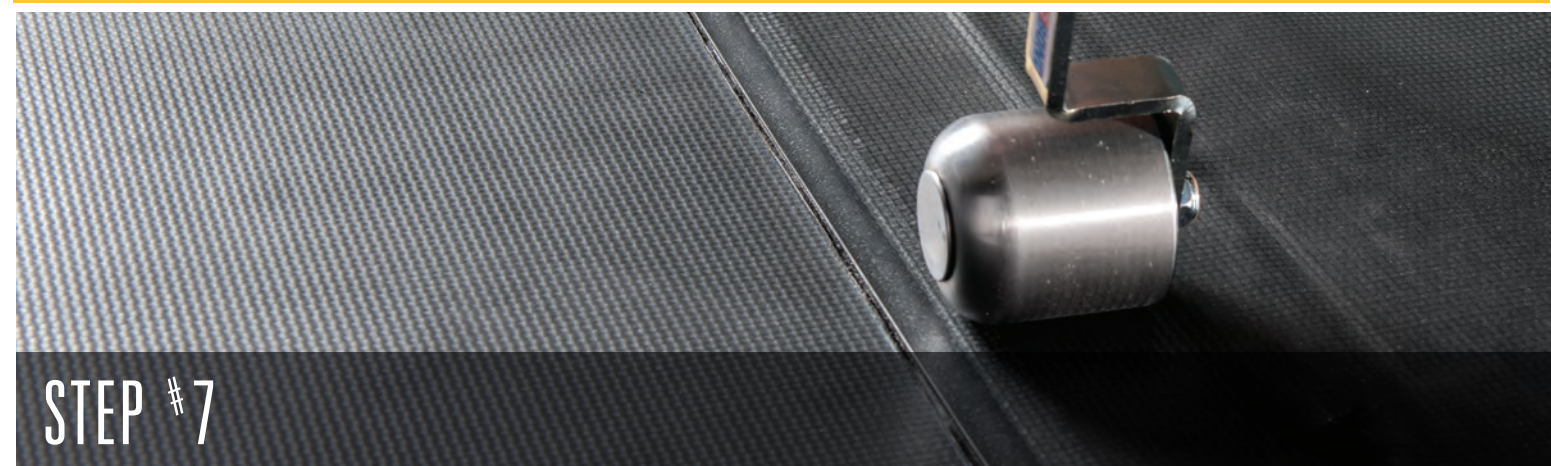

STEP #7

HAND-ROLL LAP LINE

To ensure proper lap adhesion around the batten strip, hand-roll with a 2"-wide roller along both sides of the splice of the polymer batten strip.