

ISOMETRIC VIEW

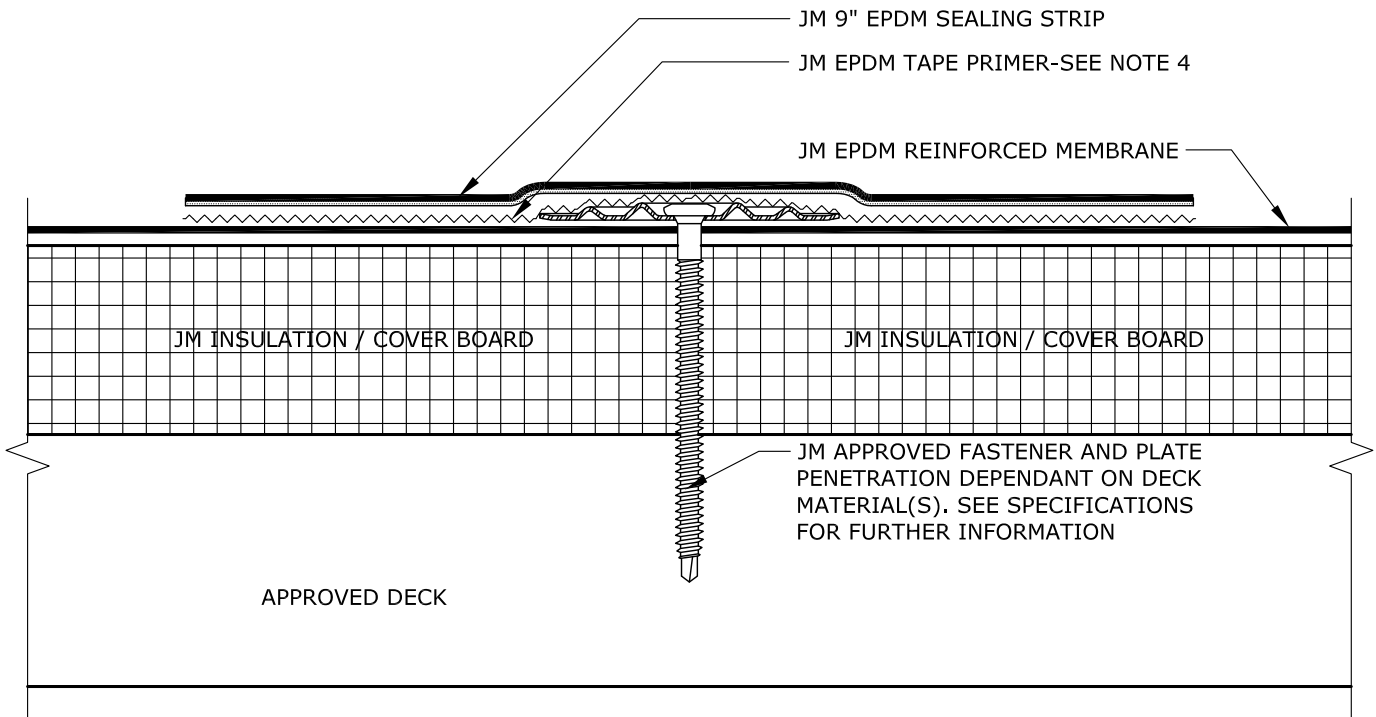

NOTES:

1. REFER TO JOHNS MANVILLE WEBSITE (www.jm.com) FOR THE MOST CURRENT INFORMATION.
2. REFER TO SINGLE PLY FLASHING SPECIFICATIONS FOR INSTALLATION INSTRUCTIONS AND REQUIREMENTS WHICH ARE PART OF THIS DETAIL.
3. ANY CARPENTRY, METAL WORK, OR MASONRY CONSTRUCTION SHOULD BE DESIGNED AND CONSTRUCTED IN ACCORDANCE WITH LOCAL CODE REQUIREMENTS AND/OR PROJECT SPECS. THESE COMPONENTS SHOULD BE REVIEWED AND APPROVED BY A LICENSED DESIGN PROFESSIONAL.
4. JM EPDM TAPE PRIMER OR JM SINGLE PLY MEMBRANE PRIMER (LOW VOC) MUST BE APPLIED ON ALL SURFACES COMING INTO CONTACT WITH JM EPDM PEEL & STICK PRODUCTS. ROLL MEMBRANE WITH HAND ROLLER UNDER PRESSURE AT SEAM.

DRAWING NO.

E-MS-11

REPLACES EL-18T

CONTINUOUS STRIP FASTENING METHOD

MEMBRANE TYPE:
JM EPDM

MAXIMUM GUARANTEE TERM:
20 YEAR

SCALE: N.T.S.
ISSUE DATE: 1-10-17

Johns Manville is a manufacturer of commercial roofing products and offers this general conceptual information to you as a courtesy. This complimentary assistance is not to be used or relied upon by anyone as a substitute for professional engineering design and documentation required by building code, contract, or applicable law. By accepting these comments you agree they do not constitute any representations, endorsements of, or an assumption by Johns Manville of any liability for either the adequacy of the design of this building or any other material not supplied by Johns Manville.

