

8" (203 mm) MIN. (SEE NOTE 4)

4" (102 mm)

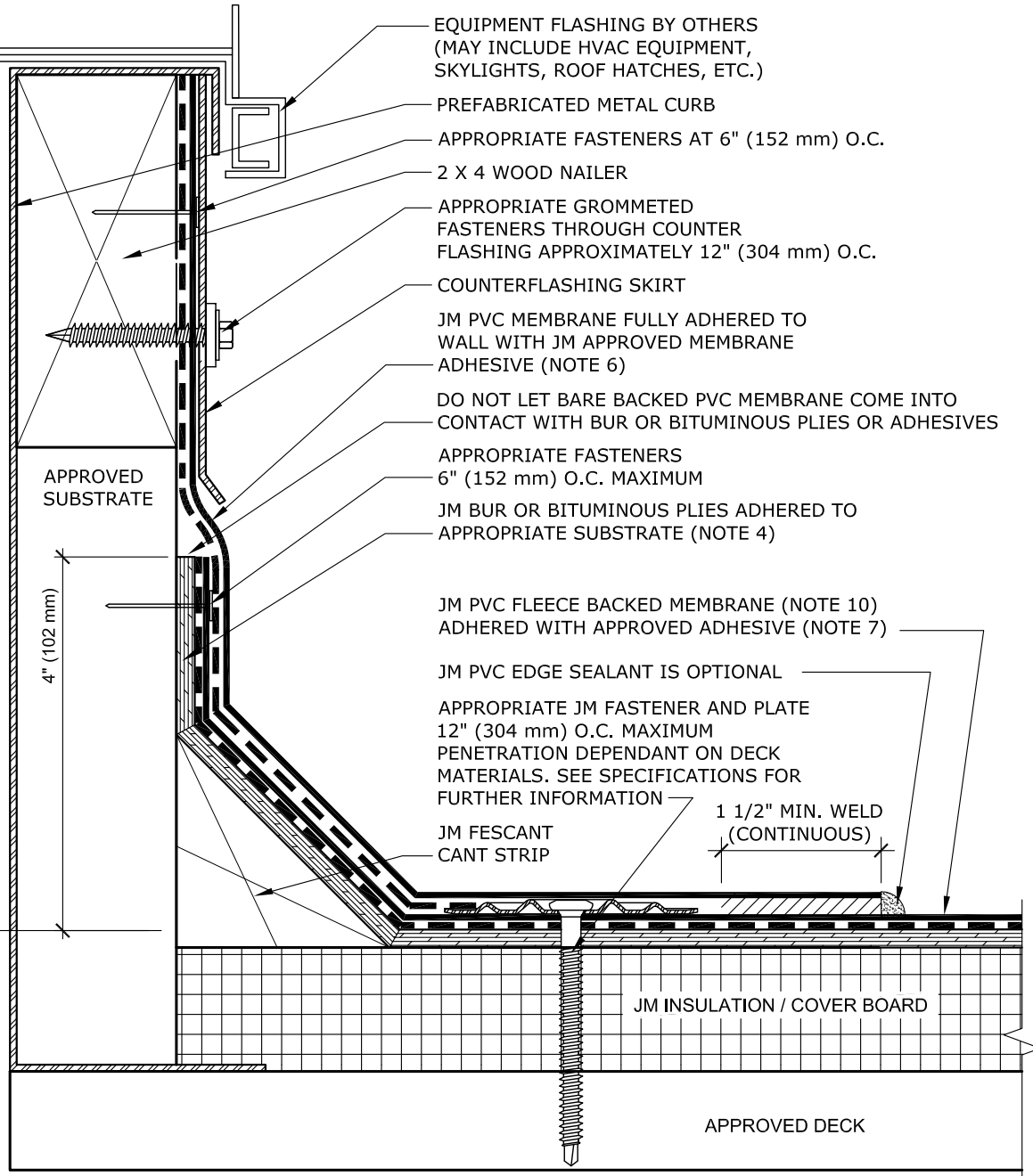

**NOTES:**

1. REFER TO JOHNS MANVILLE WEBSITE ([www.jm.com](http://www.jm.com)) FOR MOST UP-TO-DATE INFORMATION.
2. PLEASE SEE SINGLE PLY FLASHING SPECIFICATIONS FOR A FULL DESCRIPTION OF INSTALLATION INSTRUCTIONS AND REQUIREMENTS WHICH ARE CONSIDERED A PART OF THIS DETAIL.
3. ANY CARPENTRY OR METAL WORK SHOULD BE DESIGNED AND CONSTRUCTED IN ACCORDANCE WITH LOCAL CODE REQUIREMENTS AND/OR PROJECT SPECIFICATIONS. THESE COMPONENTS SHOULD BE REVIEWED AND APPROVED BY A LICENSED DESIGN PROFESSIONAL.
4. BITUMINOUS PLIES INCLUDE APPROPRIATE SMOOTH JM SBS MODIFIED BITUMEN SHEETS APPLIED WITH HOT ASPHALT, MBR COLD APPLICATION ADHESIVE, OR HEAT WELDING TECHNIQUES AND/OR PLY FELTS APPLIED IN HOT ASPHALT.
5. JM PVC EDGE SEALANT IS OPTIONAL ON ALL CUT OR NON-ENCAPSULATED EDGES OF REINFORCED MEMBRANE. THIS INCLUDES FACTORY CUT MEMBRANE. SEE DETAIL PH-MS-01.
6. JM APPROVED ADHESIVES FOR USE ON VERTICAL FLASHING APPLICATIONS INCLUDES JM PVC MEMBRANE ADHESIVE (LOW VOC), AND PVC MEMBRANE ADHESIVE (WATER BASED).
7. JM APPROVED ADHESIVES FOR JM TPO FLEECE BACKED MEMBRANE ADHERED OVER BITUMINOUS PLIES INCLUDE HOT ASPHALT, RSUA OR 2P UIA CANISTER.
8. HEIGHT OF CURB TO BE ADJUSTED WITH NAILERS. IT IS PREFERRED TO RAISE CURB ONTO NAILERS TO EXTEND FLASHING HEIGHT.
9. SEE PH-FW-B DETAILS FOR JM APPROVED BASE FLASHING TIE IN TERMINATION METHODS.
10. JM PVC FLEECE BACKED MEMBRANE OPTIONS INCLUDE JM PVC FB WITH DOW™ ELVOY® KEE POLMER AND JM PVC SD PLUS FB.

DRAWING NO.

**PH-FC-01**

**PREFABRICATED METAL CURB BASE FLASHING WITH CANT**

MEMBRANE TYPE:  
JM PVC FLEECE BACK HYBRID

Johns Manville is a manufacturer of commercial roofing products and offers this general conceptual information to you as a courtesy. This complimentary assistance is not to be used or relied upon by anyone as a substitute for professional engineering design and documentation required by building code, contract, or applicable law. By accepting these comments you agree they do not constitute any representations, endorsements of, or an assumption by Johns Manville of any liability for either the adequacy of the design of this building or any other material not supplied by Johns Manville.

SCALE  
N.T.S

ISSUE DATE  
12-07-23

MAXIMUM GUARANTEE TERM:  
30 YEAR

